



A COVID-19 Virtual Ideation Experience

Workplace Wellbeing

Team Number: Academic

The Team

Team Leader: Dr. Elaine **Worzala** , Director of the Carter Real Estate Center at the College of Charleston

Dr. Sofia **Dermisi** , Professor, University of Washington

Mason **Cohen** , Student, College of Charleston

John **Edwards** , Student, College of Charleston

Chloe **Heiligenstein** , Student, College of Charleston

Nicole **Kerr** , Student, University of Washington

Sam **Ohaus** , Student, College of Charleston

David **Schacter** , Student, University of Massachusetts, Amherst

Joseph **Velasquez** , Student, College of Charleston

Satya **Vyakaranam** , Student, University of Washington



COLLEGE of
CHARLESTON
SCHOOL OF BUSINESS



UNIVERSITY of
WASHINGTON





IDEA



CONNECT



SOLVE



PRESENT

A COVID-19 Virtual Ideation Experience

Slide 1

CoWorking Under Pressure: Estimated Exposure by Market

% OF OFFICE INVENTORY LEASED BY COWORKING / FLEXIBLE OFFICE OPERATORS

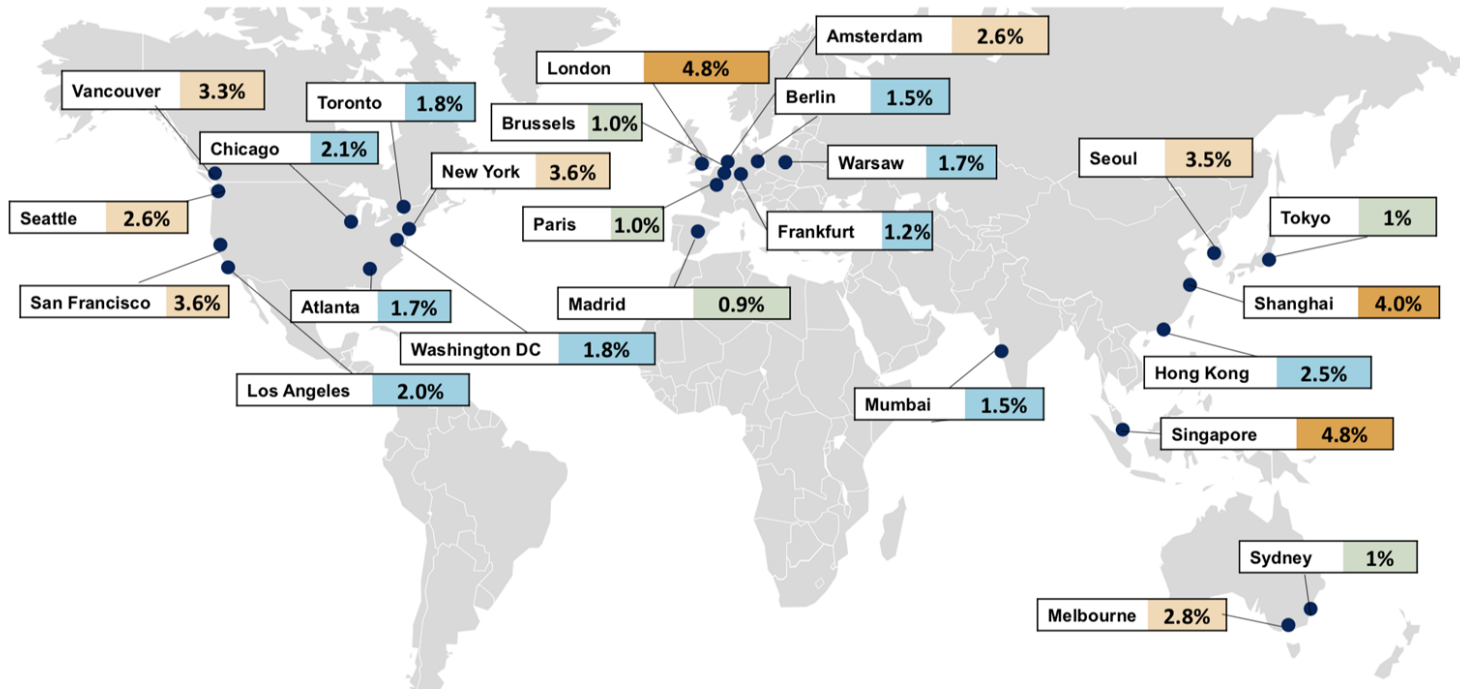

A combination of long-term lease liabilities with short term lease revenues puts a squeeze on coworking business models. Global office markets with greater exposure to these types of tenants could see a larger impact.



A COVID-19 Virtual Ideation Experience

Slide 2

Six Readiness Essentials

Prepare the building	Prepare the workforce	Control Access	Create a Social distancing plan	Reduce touch points and increase cleaning	Communicate for confidence
<ul style="list-style-type: none"> • Janitorial maintenance plans • Pre-return inspections • HVAC & Mechanical check 	<ul style="list-style-type: none"> • Mitigating anxiety – re-assuring the workforce • Policies for deciding who returns • Employee communication 	<ul style="list-style-type: none"> • Protocols for safety and health checks – infra-red tem checks • Building reception – hands free • Shipping and receiving • Elevators – hands free • Visitor policies 	<ul style="list-style-type: none"> • Decreasing density – revising capacity and reducing by XX% • Schedule management • Office traffic patterns 	<ul style="list-style-type: none"> • Open doors • Clean desk policy • Food plan • Cleaning common areas 	<ul style="list-style-type: none"> • Recognize the fear in returning • Communicate transparently

Source: Cushman & Wakefield (<https://www.cushmanwakefield.com/en/netherlands/six-feet-office>)



A COVID-19 Virtual Ideation Experience

Slide 3

Six Feet Office - Cushman & Wakefield

- 01** BE WELCOME AT WORK, BUT ALWAYS ACT RESPONSIBLY
- 02** STICK TO THE RULES, FOLLOW THE SIGNS
- 03** STAY SAFE AT 6 FEET FROM EACH OTHER
- 04** WALK THE OFFICE CLOCKWISE, ALWAYS AND EVERYWHERE
- 05** ENTER AND LEAVE MEETING ROOMS AS INDICATED
- 06** REPLACE YOUR DESKPAD DAILY AND LEAVE A CLEAN DESK

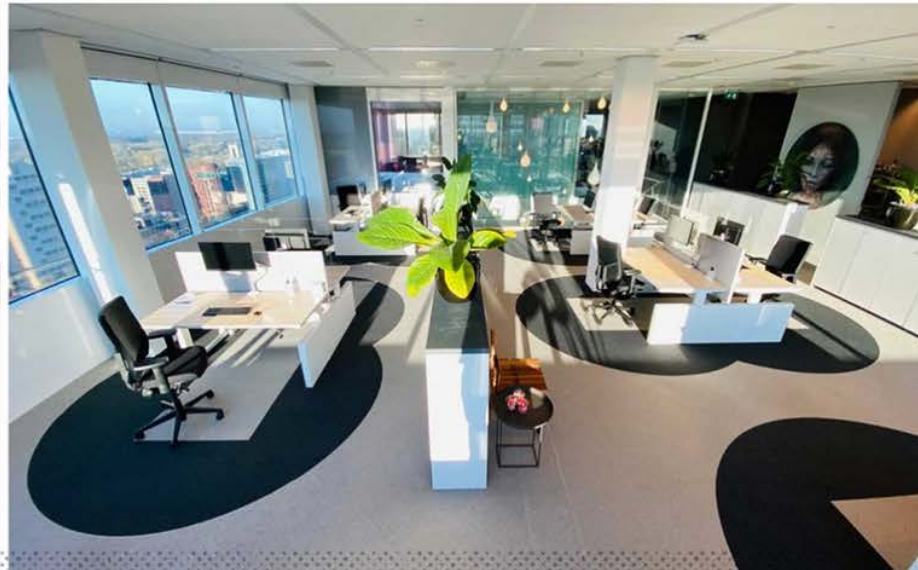



A COVID-19 Virtual Ideation Experience

Slide 4

Fitwel Air Ventilation Recommendations

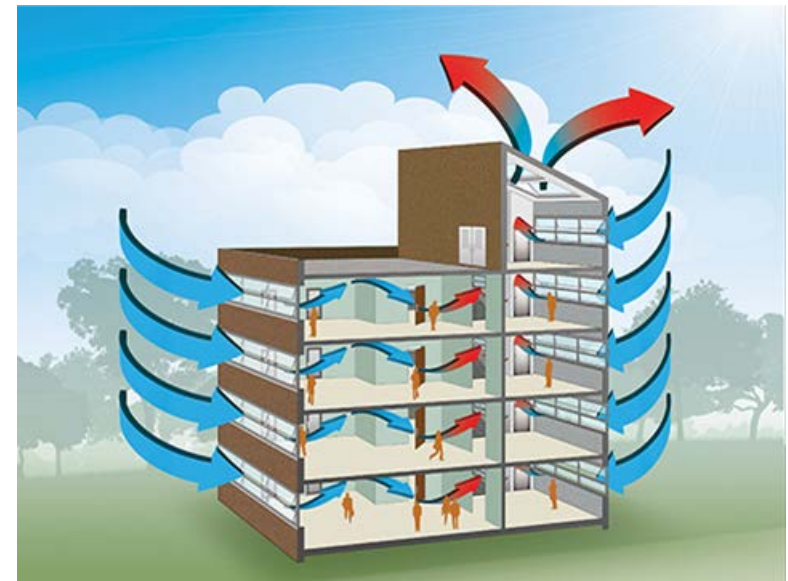



A COVID-19 Virtual Ideation Experience

Slide 5

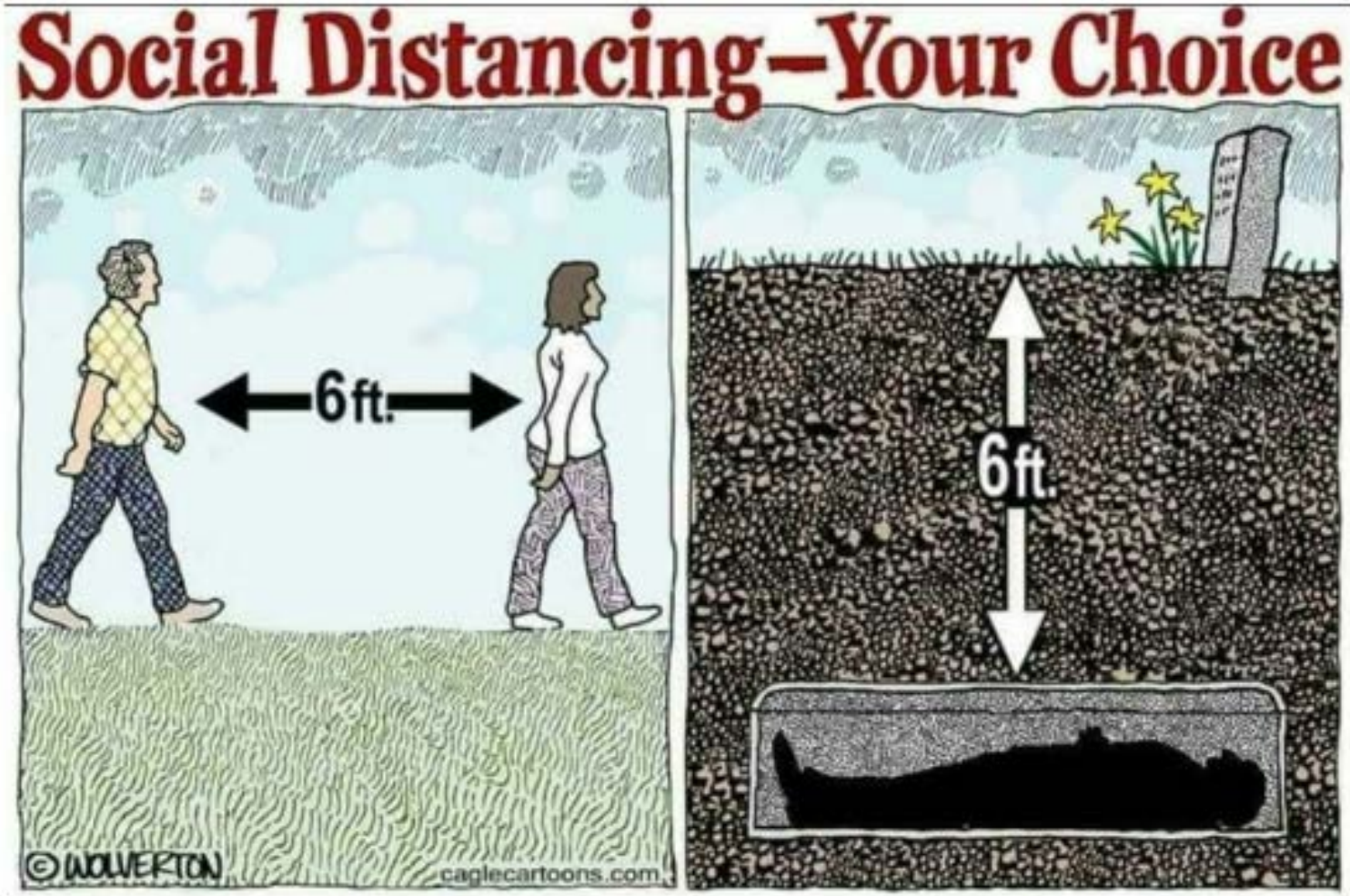



A COVID-19 Virtual Ideation Experience

Slide 6

Background References:

- ❑ Health & Safety, Govt. of Yukon <http://healthandsafety.gov.yk.ca/our-health-safety-system/safe-work-practices-and-safe-job-procedures/office-hygiene>
- ❑ BC Campus Open Education <https://opentextbc.ca/foodsafety/chapter/workplace-sanitation/>
- ❑ CoStar https://product.costar.com/home/news/shared/674044510?utm_source=newsletter&utm_medium=email&utm_campaign=personalized&utm_content=p1
- ❑ ALSCO <https://www.alsco.com.au/2017/03/employee-workplace-hygiene-safety/>
- ❑ Thermal Image Scanning for Influenza Border Screening: Results of an Airport Screening Study
Patricia C. Priest , Alasdair R. Duncan , Lance C. Jennings and Michael G. Baker
- ❑ CDC <https://www.cdc.gov/coronavirus/2019-ncov/downloads/workplace-school-and-home-guidance.pdf>
- ❑ WHO <https://www.who.int/docs/default-source/coronaviruse/getting-workplace-ready-for-covid-19.pdf>
- ❑ HqO https://www.hqo.co/?gclid=Cj0KCQjwka_1BRCPARIsAMIUmEqumqpDkjBjUICdaG0UmUGyLKPMxso_gn9OMcdgdzG_sW4znE07pscoaAr_zEALw_wcB



A COVID-19 Virtual Ideation Experience

Slide 7

Background References:

- ❑ Cretech <https://www.cretech.com/event/preparing-the-built-world-for-the-new-normal-part-5/>
- ❑ World Economic Forum <https://www.weforum.org/agenda/2020/05/protecting-office-workers-vital-for-relaxing-lockdown-south-korea/>
- ❑ Recover Readiness - A how-to guide to reopening your workplace
- ❑ Gartner <https://www.gartner.com/smarterwithgartner/4-ways-to-ensure-social-distancing-for-on-site-service-employees/>
- ❑ Buro Happold <https://www.burohappold.com/articles/social-distancing-in-the-workplace/>